

# PRIMEWORLD LIMITED

## TXL38 RANGE OF POWER FACTOR CORRECTION INDUCTORS

### PRELIMINARY DATA

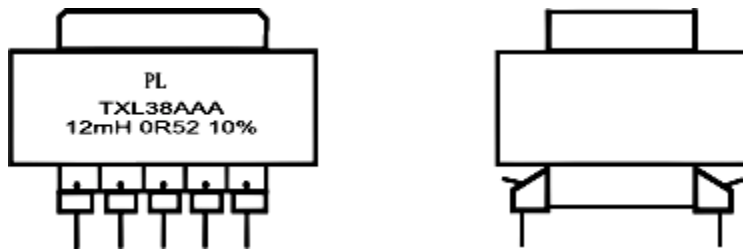

### TECHNICAL DESCRIPTION:

**Primeworld** TXL38--- range of inductors is designed to reduce mains harmonic currents drawn by electrical equipment to within Class A levels as defined by IEC61000-3-2/BSEN61000-3-2 specifications that set limits for harmonic current emissions.

E-I 38 laminated iron cores used in TXL38 range achieve high inductance values within a small volume. Windings are enamelled copper wire wound on a custom made bobbin that allows extra winding space to minimise winding resistance. Entire assembly is polyurethane vacuum impregnated to minimise mains hum.

The TXL38 range is designed for use in series with ac mains input lines and input filter circuits of power supplies. High differential inductance of TXL38 range is also very effective in reducing conducted noise emissions of switch mode power supplies.

TXL38AAA is designed for equipment with input power ratings of up to 400W. TXL38BAA, with forced air cooling, is suitable for equipment with input power ratings of up to 600W.

### RATINGS AND CHARACTERISTICS:

**Maximum Working Voltage:** 250V ac rms. 400V dc

**Rated current:** See table for TXL38 range

**Inductance:** See table for TXL38 range

**DC Resistance:** See table for TXL38--- range

**Climatic category:** 25/105/56

**Maximum temperature range:** Operating: -25 to +105 °C

Storage: -55 to 125 °C

<b>Mass:</b>	TXL38AAA	160g max
	TXL38BAA	200g max

**TXL38--- RANGE:**

	NOMINAL	DC	CONTINUOUS	CONTINUOUS	SATURATING
CODE	INDUCTANCE	RESISTANCE	CURRENT	CURRENT	CURRENT
<i>TXL38</i>	$L_n$ (mH) @ 1KHz	(OHM) MAX	ac rms (A) @ 60° C	ac rms (A) Forced air *	Peak (A) @ 90% $L_n$
TXL38AAA	12	0.52	2.2	2.4	3.5
TXL38BAA	14	0.6	2.2	3.2	4.7

**Mechanical Data**

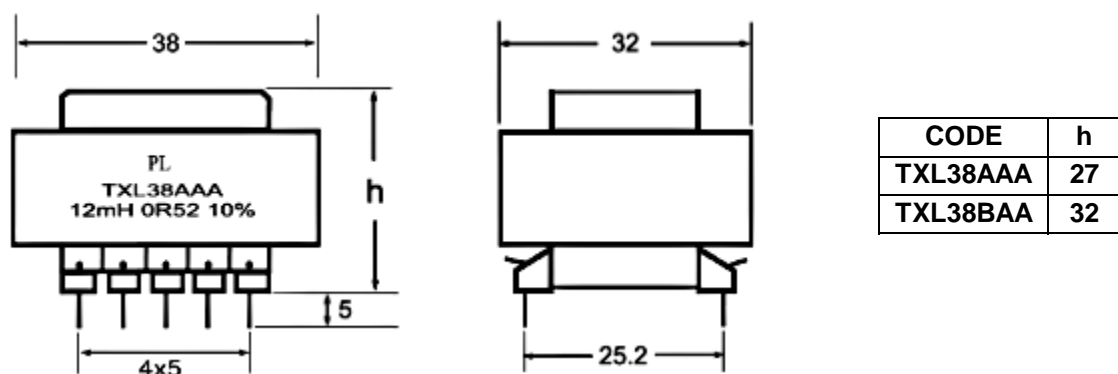

PIN DIMENSIONS: 1.2mm x 0.4mm All dimensions are in mm. Tolerances: +/-5%

**INSPECTION REQUIREMENTS**

Visual inspection: Random Sample

Failure Criteria:

- |         |  |
|---------|--|
| Marking | - Non-legible, missing or double marking.  |
| Package | - Dimensions out of tolerance.<br>- Contamination by oil, flux, etc.   |
| Leads   | - More than 10% non-plated surface in the soldering area.<br>- Blistering, peeling or other surface defects exposing base material<br>- Contamination by oil, flux, etc. |
| Packing | - Inconsistent mechanical strength.<br>- Incorrect quantity, type, labelling and sealing.  |

Inductance: 100% **Limits:** +/-10%

DC resistance: 100% **Limits:** +5% -10%.

*Specifications and information contained in this data sheet are intended for guidance only. The Company's policy is one of continuous improvement, and the right to change materials, designs, dimensions and descriptive matter, etc. at any time without notice is reserved. Primeworld shall not be liable for any loss, direct or consequential, which may result from the use of this information. . © 2002 Primeworld Limited*

**PRIMEWORLD LIMITED**

Derwent, Sawbridgeworth Road, Hatfield Heath, Bishop's Stortford, HERTS, CM22 7DR

Tel: 01279 730031 Fax: 01279 731113 e-mail: [sales@primeworld.co.uk](mailto:sales@primeworld.co.uk)